

iPad 2 connection to the WUR Wireless network.

Go to the home screen of the iPad



Tap on the Settings icon

Check if the General settings are selected.



Tap on Network in the column on the right.



Tap on Wi-Fi on the right.

The available Wi-Fi networks will be shown



Do you have a personal WURnet account? Tap on wur-user of eduroam when you want to use Wi-Fi network on other universities with a eduroam network.

When you have a WUR wireless-guest account? Tap on wur-guest.

When you do not have a WURnet account and you are not from a EDUroam participating institution? A WUR Wireless Guest account must be created first. See <http://wireless.wur.nl/default.html#4>

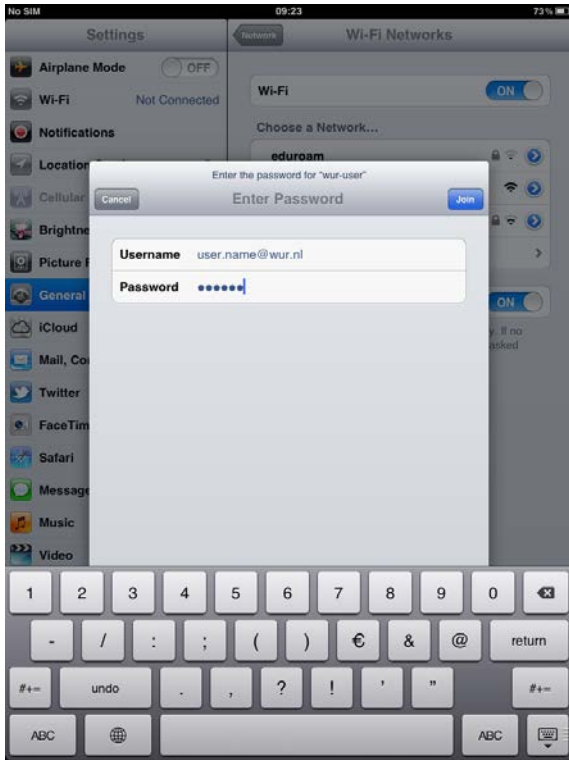

Enter your email adres and passwordn and tap on Join

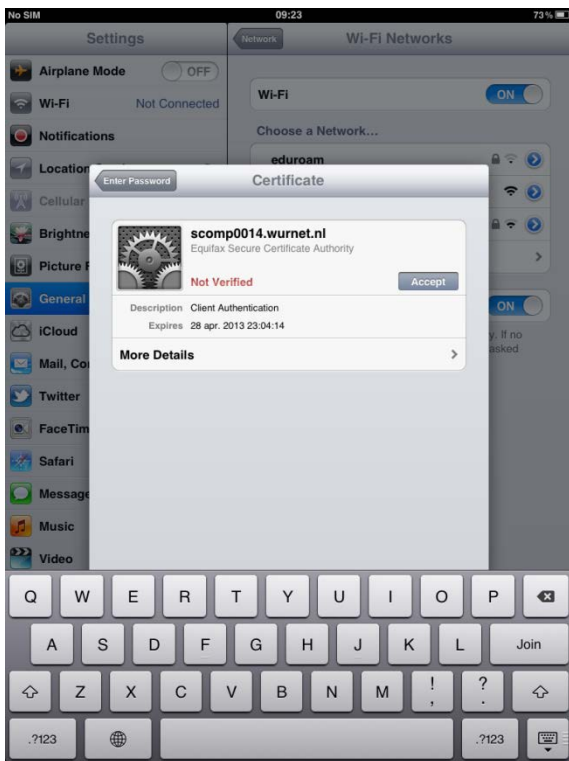

Tap on Accept to accept the certificate.

When the network connection has succeeded you will see the Wi-Fi icon in the left top corner and a check mark besides the Wi-Fi network you have chosen.



Tap on Network to go back



Tap on General to return to the General Settings.

Press the Home button to return to the Home screen.

Continue with the next step