

# Setting up Wireless connection with Windows 10

---

## Introduction

This instruction will give you some information how to connect your own computer to the Wireless network of Wageningen UR. These instructions will explain how to do that.

## Requirements

- A WURnet-account. This is your employee or student account with associated password.
- Make sure that your wireless network card is switched on.



## Guide

- Click the wireless network indicator  in the taskbar.
- Select *wur-user*
- Mark '*Connect automatically*' and click Connect.
- The following message is shown:

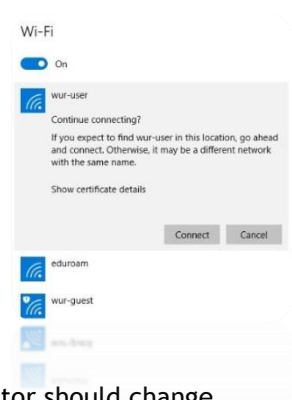

- In the *Username* section type your Wageningen UR email address (**firstname.lastname@wur.nl**).
- In *Password* section type the corresponding password.
- The next warning messages can be safely ignored, please continue with Connect.



You're now connected to WUR wireless network, the wireless network indicator should change from  to . See [wireless.wur.nl/connectivity](https://wireless.wur.nl/connectivity) for frequently asked questions (FAQ) and other information.

